



Schoolhouse Square

58 New Energy-Efficient Homes in Neptune Township

Affordable Townhomes under \$160k*

Choice Townhomes under \$200k

Twins at \$226k

*Limited number of units available. Deed restrictions apply



For more information, please contact:

Interfaith Neighbors 732-775-5373



- Features include:**
- 3 bedrooms
 - 1.5 or 2.5 bathrooms
 - Energy-efficient
 - Modern kitchen
 - Central A/C and heat
 - 2 parking spaces
 - Spacious front porch
 - Large storage area in attic

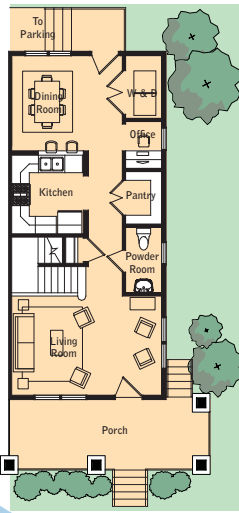

First Floor (680 sq.ft.)

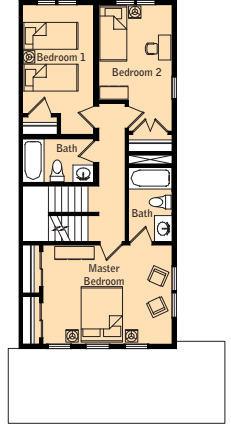

Second Floor (680 sq.ft.)

- 1 Mile to the Shore
- Walking Distance to Train Stations
- 5 Mins to Garden State Parkway (Exit 100)
- Close to Schools, Shopping & Jersey Shore University Medical Center

Welcome Home!

For more Information, please contact:

Interfaith Neighbors 732-775-5373

PROJECT TEAM

TRF Development Partners

is a regional non-profit organization that addresses the current limitations of housing development and works to increase homeownership opportunities in urban neighborhoods.

Interfaith Neighbors, Inc. is

a non-profit organization whose mission is to make a difference in the lives of the working poor, the elderly, shut-ins, disadvantaged youth and neighborhoods in need of revitalization in Monmouth County.

CityWorks is a non-profit

organization created to assist in the development of real estate projects designed to revitalize neighborhoods throughout New Jersey.

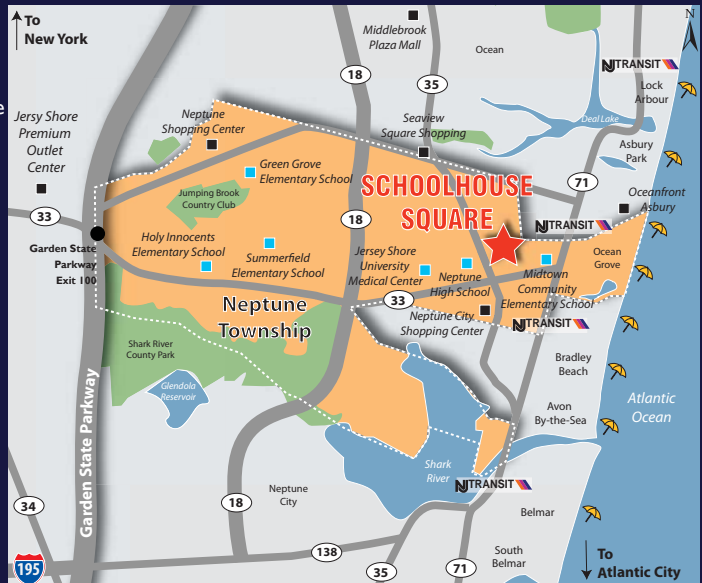

Developed by:



Terms and conditions subject to change without notice. Due to continuing improvement in plans and design, the Seller reserves the right to make changes as deemed necessary without notice or obligation. Floor plans, landscape, options and elevations may vary and are not guaranteed. Square footage is approximate. Illustrations are an artist's conception and may vary in detail from actual construction. Illustrations may be shown with options. Standard features, options, terms, financing and pricing, are also subject to change without notice. Sales materials are not part of a legal contract to purchase unless specifically referenced in contract. Due to the inclusion of public funds in this development, there are specific regulations and guidelines that the Seller and Buyer must agree to follow; some of these involve income limitations and recapture provisions. Please talk to your sales representative for additional details.

